

6

5

4

3

2

1

MATERIAL AND FINISH

Insulator: Glass filled Nylon, black, UL-94-HB rated
Contacts: Phosphor Bronze, Tin plated
Spring: Spring Steel

ENVIRONMENTAL

Operating temperature: -30°C TO +70°C

RoHS
COMPLIANT

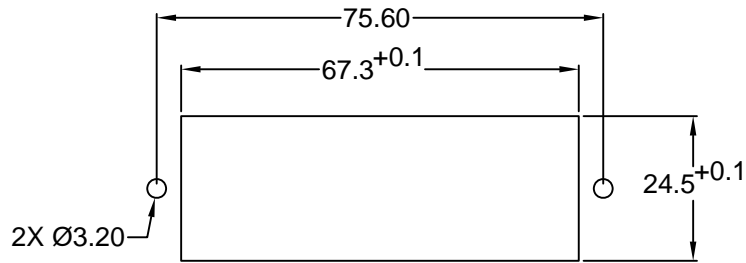

RECOMMENDED
PANEL CUTOUT

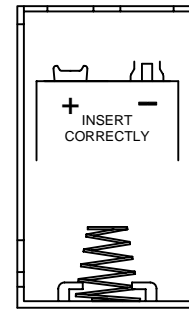
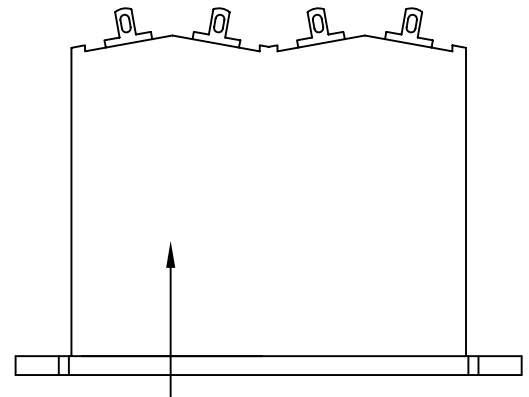

VIEW INSIDE
BATTERY
MAGAZINE

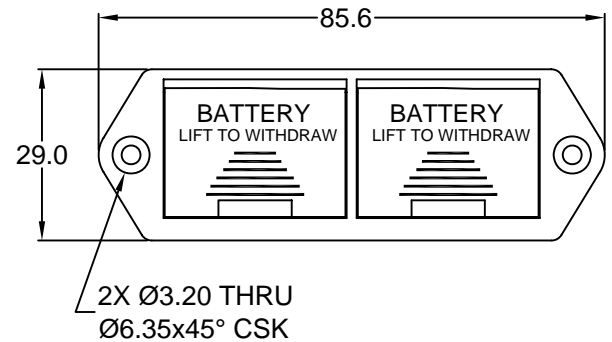
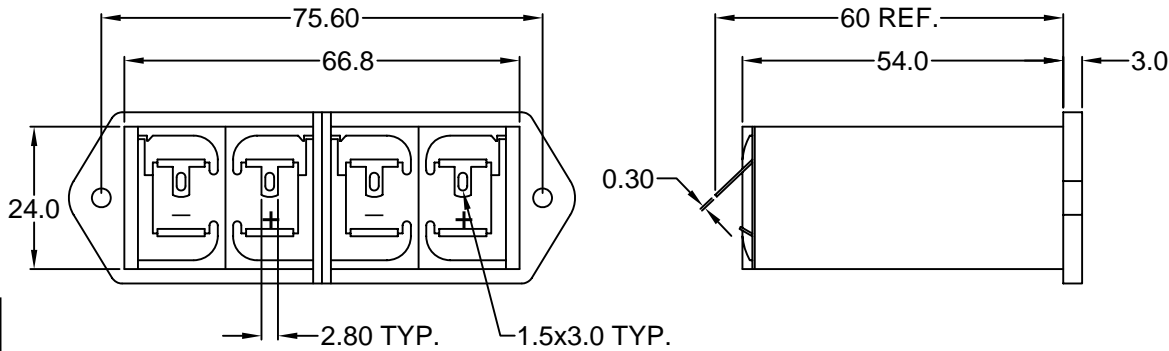

REVISIONS	CHANGE	CHNG	CHK	APPR
	REVISD / UPDTD	GO	TD	PB
	ADDED BATTERY HOLDER VIEW	DF		
	DATE			
REV	DATE			
A	02/27/02			
B	3/14/06			

TOLERANCE UNLESS OTHERWISE SPECIFIED	
X	± 1
X.X	± 0.4
X.XX	± 0.20
DRAWN BY	PB
DATE:	12/27/99
CHECK BY	TD
DATE:	12/29/99
APPR BY	JJ
DATE:	12-29-99

Power Dynamics, Inc.
Phone: 973 560-0019 Whippany, New Jersey Fax: 973 560-0076

PART: 2 CELL PP3 (6R61) 9V BATTERY HOLDER,
PANEL MOUNT, SOLDER TERMINALS

B26

PART #: B26

SIZE: A

SCALE: NTS

ALL DIMENSIONS FOR REFERENCE ONLY
DIMENSIONS ARE IN MILLIMETERS

SHEET 1 of 1

REV: B